



# TruStile's New Product Option and Product Enhancement Guide

June 2010

To support TruStile's goal of continually expanding and improving our product line, we are pleased to announce several new product options and enhancements. Our exciting new product options include two dramatic "senior" panel profiles, a sleek, modern molding profile and several new standard sash options. Our product enhancements include an Engineered LVL stile option for MDF pocket doors, a change to our stile width rules that addresses customer feedback and a new method for glazing exterior glass and mirror doors that conceals the back side of the sticking on those doors.

In order to communicate all of the important details regarding these new options to our TruStile Dealers, this guide contains in-depth descriptions, technical drawings and pricing for each new option and enhancement. It should give you everything you need to immediately begin selling these new options and enhancements to your customers. As always, if you have any questions regarding these new options or any TruStile product offering, please contact your TruStile Account Manager.

## Table of Contents

New Senior Panel Profile Options .....	2
New Quirk Moulding Profile .....	6
New Narrow OG Muntin Bar (7/8" Wide) Profile .....	10
Backside of Sticking Coated on all Exterior Glass Doors and Mirror Doors .....	11
One Step Sash Profile .....	12
Square Stick Compression Fit Option.....	13
Engineered LVL Stiles for MDF Pocket Doors .....	14
Revised Stile Width Rule Change .....	16



### **New Senior Panel Profile Options**

TruStile is expanding on its panel profile selection by adding two thicker, senior panel options to its product mix—a Senior Raised Panel (“E” Panel) and a Senior Bevel Panel (“F” Panel). Each option provides a rich, substantial look resulting from extensive panel relief and added thickness. They provide a fresh new look in either MDF or Wood and can be a very cost effective differentiator for your next house package of TruStile doors.

## Senior Raised Panel ("E" Panel) Profile



TS2070 in MDF with Bolection Moulding (BM) and Senior Raised (E) Panel



TS3150 in Hickory with Roman Ogee (OG) Sticking and Senior Raised (E) Panel

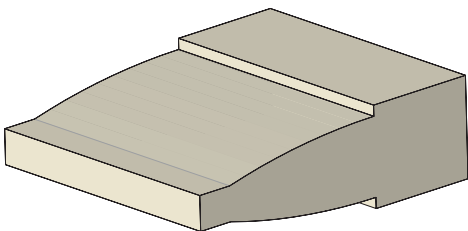

Senior Raised "E" Panel

### Senior Raised Panel ("E" Panel)

This dramatic profile with large, classical panel relief can provide a rich, yet traditional aesthetic often popular in mountain retreats or French-inspired chateaux.

**Design Idea:** Though most popular in stained wood doors, the Senior Raised panel also provides an exceptional look in painted MDF applications. Incorporate this panel profile in place of a standard raised panel and achieve dramatic results that will differentiate your customer's homes.

## Senior Bevel Panel ("F" Panel) Profile



TS3000 in MDF with Bevel (BV) Sticking and Senior Bevel (F) Panel



TS3000 in Cherry with Bevel (BV) Sticking and Senior Bevel (F) Panel

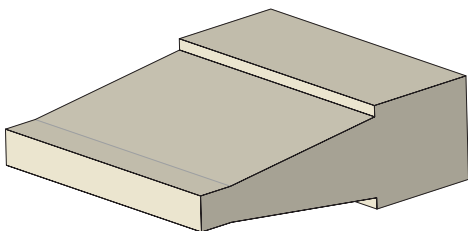

Senior Bevel "F" Panel

### Senior Bevel Panel ("F" Panel)

This new panel profile with extensive beveled relief adds an elaborate new dimension to door design. Whether your customers are building high-style, luxury lofts or sophisticated single family homes, a TruStile door with senior bevel panels will bring exceptional elegance to their projects.

**Design Idea:** Incorporate this panel profile into doors with bevel (BV) sticking and large panels to create a dramatic design element in either paint grade MDF or any stain grade wood species.

# Senior Panel Technical & Pricing Information

## Senior Raised Panel ("E" Panel)

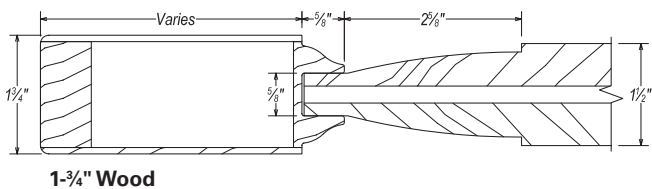
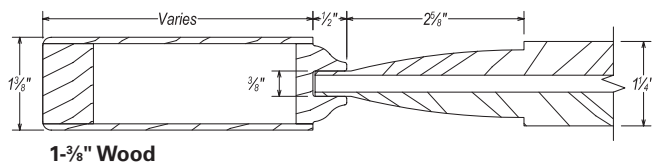
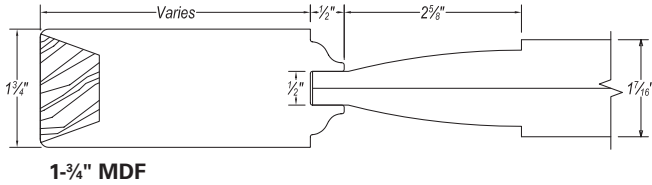
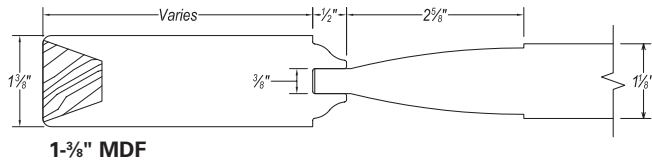

## Senior Bevel Panel ("F" Panel)

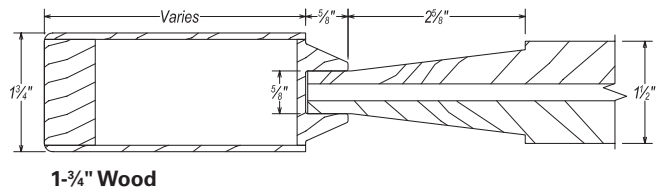
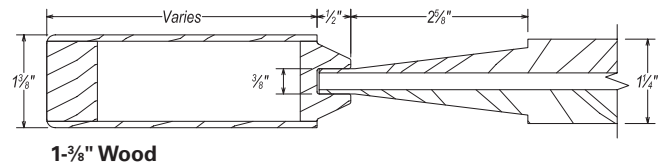
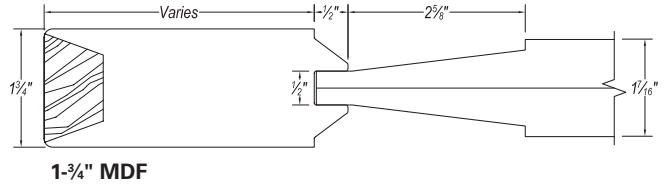
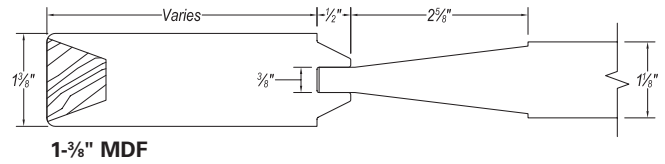

## Technical Detail

- Available in 1-3/8" and 1-3/4" thicknesses
- Over 25% thicker than TruStile's other raised panel options (up to 1-1/2" thickness on 1-3/4" thick wood doors)
- Available with all TruStile sticking options (except with LP moulding on fire doors)
- Due to small panel size, the following door styles are not available with senior raised panel profiles:  
TS3010, TS3140, TS3230, TS4190, TS4240, TS4250, TS4260, TS5030, TS5040, TS5090, TS5100, TS5110, TS5120, TS6010, TS6040, TS7000, TS7010, TS7020, TS9000, TS9010, FL202, FL303, PL202, PL330, PL332, PL333, PL334, PL336, PL343, PL344, PL410

## List Adder Pricing for "E" and "F" Panels

Material	List Adder
MDF	\$20
Cherry	\$266
Clear Pine	\$210
Douglas Fir	\$346
European Beech	\$206
Hickory	\$160
Knotty Alder	\$92
Knotty Pine	\$126
Mahogany	\$344
Paint-grade Poplar	\$112
Stain-grade Poplar	\$138
Red Oak	\$156
Select Alder	\$154
Walnut	\$288
White Maple	\$170
White Oak	\$182



Detail of Maple Quirk Moulding on Mahogany Door



Detail of Quirk Moulding in MDF

TS3000 in Mahogany with Flat (C) Panel and Contrasting Maple Quirk (QM) Moulding

# Quirk Moulding (QM) Profile Option

## Quirk Moulding (QM)

*A Cost Effective Modern Option That Provides a Great Alternative to a Flush Door*

All too often it seems that modern homes end up with the cold, industrial look of a flush door when better, more interesting options are available in stile and rail construction. TruStile's new Quirk Moulding adds a clean, unique dimension to any door with square sticking—offering a modern look with more dimension and detail than a traditional flush door.

Popular on one panel doors, Quirk Moulding has often been used to “dress up” a square stick, flat panel profile to achieve a more contemporary flair. Quirk Molding is a cost effective option to incorporate into any door, with significantly lower adder prices than traditional applied molding options.

Be sure to offer Quirk Moulding the next time your customer wants a unique door that achieves a clean, modern look.

**Design Idea:** Achieve dramatic results on your wood door by selecting a different, contrasting wood species for the Quirk Moulding inlay. There is no upcharge for a Quirk Moulding inlay in another standard wood species.

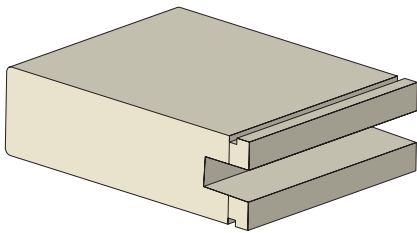

Quirk Moulding (QM)

### Technical Detail

- Available in all TS and TSL series door styles and FL and PL series door styles without muntin bars
- Available in 1-3/8" and 1-3/4" thicknesses
- Recommended with a “C” flat panel profile but also available with TruStile’s other panel profiles
- TSL series door styles require glass to be compression fit

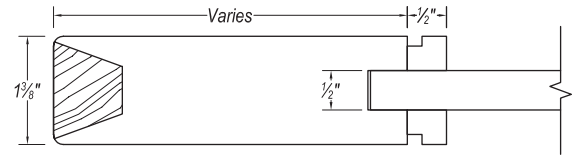

1-3/8" MDF

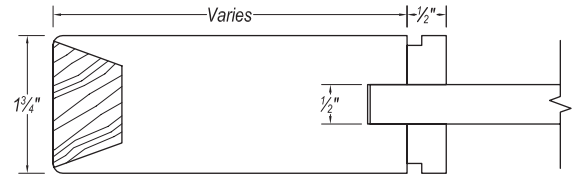

1-3/4" MDF

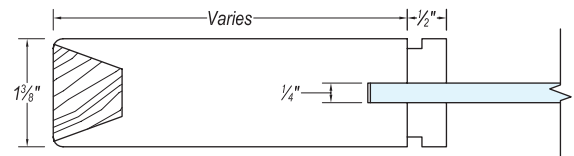

1-3/8" MDF/Glass

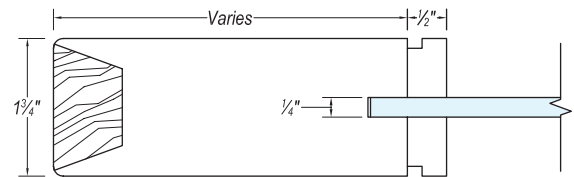

1-3/4" MDF/Glass

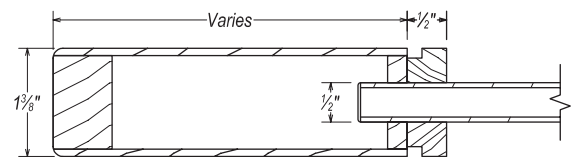

1-3/8" Wood

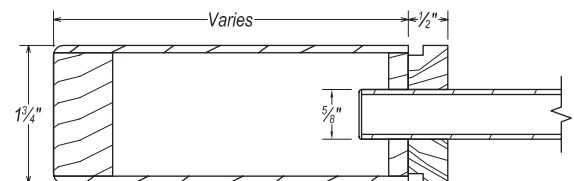

1-3/4" Wood

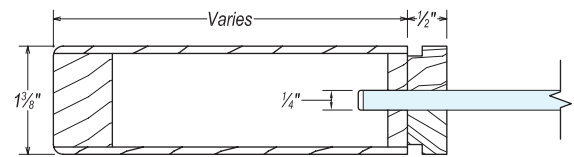

1-3/8" Wood/Glass

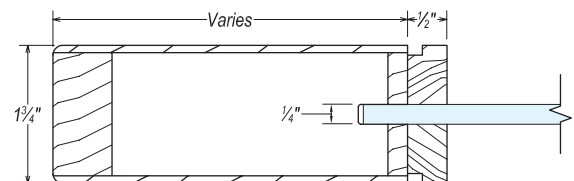

1-3/4" Wood/Glass

## Quirk Moulding (QM) List Adder Prices

The price grids below reflect list adder prices for the Quirk moulding profile option. Price your chosen door style as you normally would using either TruCAD or our price book, then add the applicable adder from the grid below before applying your multiplier. Note: Quirk moulding is not available on glass door styles with muntin bars.

Door Style	MDF	Wood	Door Style	MDF	Wood	Door Style	MDF	Wood	Door Style	MDF	Wood
TS1000	\$59	\$215	TS3130	\$80	\$261	TS4140	\$89	\$307	TS6000	\$97	\$460
TS1010	\$95	\$276	TS3140	\$163	\$514	TS4142	\$73	\$245	TS6003	\$80	\$368
TS1020	\$118	\$338	TS3150	\$107	\$322	TS4150	\$222	\$611	TS6010	\$107	\$460
TS1030	\$96	\$276	TS3160	\$207	\$326	TS4153	\$207	\$488	TS6012	\$73	\$230
TS1040	\$118	\$338	TS3170	\$207	\$326	TS4160	\$237	\$828	TS6014	\$89	\$368
TS1050	\$118	\$399	TS3180	\$148	\$445	TS4162	\$194	\$663	TS6020	\$107	\$460
TS2000	\$73	\$215	TS3190	\$80	\$261	TS4170	\$118	\$326	TS6023	\$80	\$368
TS2001	\$65	\$160	TS3192	\$73	\$208	TS4173	\$107	\$261	TS6030	\$148	\$560
TS2010	\$107	\$276	TS3200	\$222	\$345	TS4180	\$202	\$648	TS6033	\$107	\$448
TS2011	\$95	\$221	TS3210	\$148	\$445	TS4190	\$89	\$307	TS6040	\$157	\$579
TS2020	\$66	\$215	TS3220	\$80	\$261	TS4192	\$73	\$153	TS6043	\$107	\$290
TS2030	\$94	\$276	TS3230	\$245	\$717	TS4193	\$80	\$245	TS6044	\$126	\$463
TS2040	\$94	\$276	TS3240	\$80	\$261	TS4200	\$89	\$307	TS6050	\$107	\$460
TS2050	\$134	\$338	TS3242	\$72	\$208	TS4203	\$80	\$245	TS6053	\$80	\$368
TS2060	\$73	\$215	TS3250	\$80	\$261	TS4210	\$89	\$307	TS6060	\$157	\$659
TS2070	\$126	\$399	TS3260	\$148	\$445	TS4220	\$89	\$307	TS6063	\$107	\$528
TS2080	\$134	\$338	TS3262	\$126	\$356	TS4230	\$80	\$307	TS6070	\$148	\$560
TS2090	\$148	\$399	TS3270	\$164	\$430	TS4232	\$73	\$232	TS6073	\$107	\$448
TS2091	\$118	\$299	TS3272	\$134	\$344	TS4250	\$80	\$307	TS6080	\$107	\$460
TS2130	\$107	\$276	TS3280	\$80	\$246	TS4252	\$65	\$232	TS6083	\$80	\$368
TS2131	\$95	\$89	TS3290	\$80	\$246	TS4253	\$74	\$262	TS6090	\$172	\$683
TS2140	\$107	\$215	TS3292	\$73	\$145	TS4260	\$80	\$307	TS6093	\$148	\$546
TS2150	\$194	\$476	TS3300	\$80	\$261	TS4262	\$65	\$232	TS6100	\$148	\$560
TS2160	\$194	\$460	TS3302	\$72	\$208	TS4263	\$74	\$262	TS6103	\$107	\$448
TS2170	\$104	\$276	TS4000	\$80	\$307	TS5000	\$104	\$383	TS6110	\$97	\$348
TS2180	\$104	\$276	TS4002	\$73	\$245	TS5010	\$134	\$483	TS6120	\$97	\$348
TS2190	\$126	\$399	TS4010	\$126	\$406	TS5013	\$107	\$387	TS6123	\$80	\$278
TS2200	\$73	\$215	TS4012	\$104	\$325	TS5020	\$237	\$721	TS7000	\$172	\$656
TS2210	\$73	\$215	TS4020	\$118	\$387	TS5023	\$207	\$577	TS7003	\$107	\$328
TS3000	\$80	\$261	TS4023	\$107	\$310	TS5030	\$104	\$383	TS7004	\$126	\$525
TS3010	\$80	\$261	TS4030	\$194	\$545	TS5033	\$80	\$192	TS7010	\$172	\$537
TS3011	\$65	\$261	TS4032	\$134	\$436	TS5034	\$89	\$307	TS7013	\$80	\$268
TS3012	\$73	\$177	TS4040	\$126	\$406	TS5040	\$157	\$503	TS7014	\$89	\$376
TS3020	\$107	\$322	TS4043	\$107	\$325	TS5043	\$107	\$251	TS7020	\$134	\$537
TS3022	\$104	\$164	TS4050	\$126	\$406	TS5044	\$126	\$402	TS7023	\$80	\$268
TS3030	\$107	\$322	TS4052	\$104	\$325	TS5050	\$134	\$483	TS7025	\$104	\$430
TS3040	\$157	\$430	TS4060	\$89	\$307	TS5053	\$107	\$387	TS8000	\$148	\$614
TS3042	\$134	\$283	TS4070	\$157	\$529	TS5060	\$94	\$383	TS8004	\$89	\$491
TS3050	\$107	\$322	TS4072	\$126	\$424	TS5063	\$80	\$307	TS8010	\$172	\$836
TS3060	\$80	\$261	TS4080	\$148	\$468	TS5070	\$237	\$721	TS8014	\$105	\$399
TS3062	\$73	\$208	TS4082	\$104	\$375	TS5073	\$207	\$577	TS9000	\$180	\$690
TS3070	\$73	\$261	TS4090	\$157	\$566	TS5080	\$104	\$383	TS9003	\$80	\$345
TS3080	\$80	\$261	TS4092	\$126	\$283	TS5090	\$104	\$383	TS9006	\$107	\$552
TS3090	\$107	\$322	TS4100	\$89	\$307	TS5093	\$80	\$192	TS9010	\$222	\$809
TS3092	\$104	\$258	TS4110	\$118	\$387	TS5094	\$89	\$307	TS9013	\$107	\$405
TS3100	\$80	\$261	TS4113	\$107	\$310	TS5100	\$256	\$667	TS9016	\$148	\$647
TS3110	\$111	\$330	TS4120	\$126	\$406	TS5110	\$384	\$928	TSL1000	\$59	\$215
TS3112	\$104	\$264	TS4123	\$107	\$325	TS5120	\$124	\$503	TSL1010	\$95	\$276
TS3120	\$111	\$330	TS4130	\$194	\$545	TS5122	\$73	\$251	TSL1020	\$118	\$338
TS3122	\$104	\$264	TS4132	\$134	\$436	TS5124	\$80	\$402	TSL1030	\$96	\$276

## Quirk Moulding (QM) List Adder Prices

Door Style	MDF	Wood	Door Style	MDF	Wood	Door Style	MDF	Wood	Door Style	MDF	Wood
TSL1040	\$118	\$338	TSL3220	\$80	\$261	TSL4230	\$80	\$307	TSL6100	\$148	\$560
TSL1050	\$118	\$399	TSL3230	\$245	\$717	TSL4233	\$73	\$232	TSL6103	\$107	\$448
TSL2000	\$73	\$215	TSL3240	\$80	\$261	TSL4250	\$80	\$307	TSL6110	\$97	\$348
TSL2001	\$65	\$160	TSL3242	\$72	\$208	TSL4252	\$65	\$232	TSL6120	\$97	\$348
TSL2010	\$107	\$276	TSL3250	\$80	\$261	TSL4253	\$74	\$262	TSL6123	\$80	\$278
TSL2011	\$95	\$221	TSL3260	\$148	\$445	TSL4260	\$80	\$307	TSL7000	\$172	\$656
TSL2020	\$66	\$215	TSL3262	\$126	\$356	TSL4262	\$65	\$232	TSL7003	\$107	\$328
TSL2030	\$94	\$276	TSL3270	\$164	\$430	TSL4263	\$74	\$262	TSL7004	\$126	\$525
TSL2040	\$94	\$276	TSL3272	\$134	\$344	TSL5000	\$104	\$383	TSL7010	\$172	\$537
TSL2050	\$134	\$338	TSL3280	\$80	\$246	TSL5010	\$134	\$483	TSL7013	\$80	\$268
TSL2060	\$73	\$215	TSL3290	\$80	\$246	TSL5014	\$107	\$387	TSL7014	\$89	\$376
TSL2070	\$126	\$399	TSL3292	\$73	\$145	TSL5020	\$237	\$721	TSL7020	\$134	\$537
TSL2080	\$134	\$338	TSL3300	\$80	\$261	TSL5024	\$207	\$577	TSL7023	\$80	\$268
TSL2090	\$148	\$399	TSL3302	\$72	\$208	TSL5030	\$104	\$383	TSL7025	\$104	\$430
TSL2091	\$118	\$299	TSL4000	\$80	\$307	TSL5033	\$80	\$192	TSL8000	\$148	\$614
TSL2130	\$107	\$276	TSL4002	\$73	\$245	TSL5034	\$89	\$307	TSL8004	\$89	\$491
TSL2131	\$95	\$89	TSL4010	\$126	\$406	TSL5040	\$157	\$503	TSL8010	\$172	\$836
TSL2140	\$107	\$215	TSL4012	\$104	\$325	TSL5043	\$107	\$251	TSL8014	\$105	\$399
TSL2150	\$194	\$476	TSL4020	\$118	\$387	TSL5044	\$126	\$402	TSL9000	\$180	\$690
TSL2160	\$194	\$460	TSL4023	\$107	\$310	TSL5050	\$134	\$483	TSL9003	\$80	\$345
TSL2170	\$104	\$276	TSL4030	\$194	\$545	TSL5053	\$107	\$387	TSL9003	\$107	\$552
TSL2180	\$104	\$276	TSL4032	\$134	\$436	TSL5060	\$94	\$383	TSL9010	\$222	\$809
TSL2190	\$126	\$399	TSL4040	\$126	\$406	TSL5063	\$80	\$307	TSL9013	\$107	\$405
TSL2200	\$73	\$215	TSL4043	\$107	\$325	TSL5070	\$237	\$721	TSL9016	\$148	\$647
TSL2210	\$73	\$215	TSL4050	\$126	\$406	TSL5073	\$207	\$577	FL100	\$65	\$216
TSL3000	\$80	\$261	TSL4052	\$104	\$325	TSL5080	\$104	\$383	FL101	\$80	\$277
TSL3010	\$80	\$261	TSL4060	\$89	\$307	TSL5090	\$104	\$383	FL102	\$80	\$277
TSL3011	\$65	\$261	TSL4070	\$157	\$529	TSL5093	\$80	\$192	FL103	\$118	\$399
TSL3012	\$73	\$177	TSL4072	\$126	\$424	TSL5094	\$89	\$307	FL110	\$81	\$216
TSL3020	\$107	\$322	TSL4080	\$148	\$468	TSL5100	\$256	\$667	FL111	\$96	\$277
TSL3022	\$104	\$164	TSL4082	\$104	\$375	TSL5110	\$384	\$928	FL112	\$96	\$277
TSL3030	\$107	\$322	TSL4090	\$157	\$566	TSL5120	\$124	\$503	FL113	\$134	\$399
TSL3040	\$157	\$430	TSL4092	\$126	\$283	TSL5122	\$73	\$251	PL100	\$73	\$197
TSL3042	\$134	\$283	TSL4100	\$89	\$307	TSL5124	\$80	\$402	PL130	\$73	\$197
TSL3050	\$107	\$322	TSL4110	\$118	\$387	TSL6000	\$97	\$460	PL145	\$73	\$197
TSL3060	\$80	\$261	TSL4113	\$107	\$310	TSL6003	\$80	\$368	PL146	\$123	\$247
TSL3062	\$73	\$208	TSL4120	\$126	\$406	TSL6010	\$107	\$460	PL200	\$80	\$197
TSL3070	\$73	\$261	TSL4123	\$107	\$325	TSL6012	\$73	\$230	PL202	\$80	\$197
TSL3080	\$80	\$261	TSL4130	\$194	\$545	TSL6014	\$89	\$368	PL220	\$80	\$197
TSL3090	\$107	\$322	TSL4132	\$134	\$436	TSL6020	\$107	\$460	PL230	\$80	\$197
TSL3092	\$104	\$258	TSL4140	\$89	\$307	TSL6023	\$80	\$368	PL300	\$89	\$213
TSL3100	\$80	\$261	TSL4142	\$73	\$245	TSL6030	\$148	\$560	PL330	\$89	\$227
TSL3110	\$111	\$330	TSL4150	\$222	\$611	TSL6033	\$107	\$448	PL360	\$80	\$213
TSL3112	\$104	\$264	TSL4153	\$207	\$488	TSL6040	\$157	\$579	PL361	\$107	\$235
TSL3120	\$111	\$330	TSL4160	\$237	\$828	TSL6043	\$107	\$290	PL362	\$107	\$235
TSL3122	\$104	\$264	TSL4163	\$194	\$663	TSL6044	\$126	\$463	PL400	\$104	\$197
TSL3130	\$80	\$261	TSL4170	\$118	\$326	TSL6050	\$107	\$460	PL410	\$104	\$197
TSL3140	\$163	\$514	TSL4174	\$107	\$261	TSL6053	\$80	\$368	PL443	\$104	\$197
TSL3150	\$107	\$322	TSL4180	\$202	\$648	TSL6060	\$157	\$659	PL444	\$104	\$197
TSL3160	\$207	\$326	TSL4190	\$89	\$307	TSL6063	\$107	\$528			
TSL3170	\$207	\$326	TSL4192	\$73	\$153	TSL6070	\$148	\$560			
TSL3180	\$148	\$445	TSL4193	\$80	\$245	TSL6073	\$107	\$448			
TSL3190	\$80	\$261	TSL4200	\$89	\$307	TSL6080	\$107	\$460			
TSL3192	\$73	\$208	TSL4204	\$80	\$245	TSL6083	\$80	\$368			
TSL3200	\$222	\$345	TSL4210	\$89	\$307	TSL6090	\$172	\$683			
TSL3210	\$148	\$445	TSL4220	\$89	\$307	TSL6093	\$148	\$546			

## Narrow OG Muntin Bar ( $\frac{7}{8}$ " wide)



TruStile's new narrow OG muntin bars ( $\frac{7}{8}$ " wide)

### **Narrow OG Muntin Bars Now a Standard Product Option for FL and PL Series Doors**

*Now your TruStile French doors can more closely match your window packages*

TruStile often fulfills requests to build our French lite interior doors with  $\frac{7}{8}$ " wide muntin bars instead of our standard  $1\frac{1}{2}$ " wide bars, especially when customers are trying to match the grills on nearby windows. We've made it easier to order this option by making narrow muntin bars ( $\frac{7}{8}$ " wide) with an OG profile a standard option for all  $1\frac{3}{8}$ " and  $1\frac{3}{4}$ " FL and PL series doors.

Simply specify that you want narrow muntin bars on any French lite door with OG sticking and you will receive that option for the same price and same lead time as our standard sized  $1\frac{1}{2}$ " muntin bars. TruStile can build other sticking profiles with  $\frac{7}{8}$ " wide muntin bars but additional tooling charges may apply. Contact your account manager for more details.

### **Technical Information**

- Narrow  $\frac{7}{8}$ " wide muntin with  $\frac{5}{16}$ " OG sticking profile
- Available with standard  $\frac{1}{4}$ " thick glass
- Available in  $1\frac{3}{8}$ " and  $1\frac{3}{4}$ " thicknesses
- Available for all standard PL and FL doors styles with muntin bars
- Not available with Thatch resin or on exterior doors
- Priced same as standard construction, specify "Narrow OG Muntin Bars" on order

Narrow OG Muntin Bar (7/8" wide)

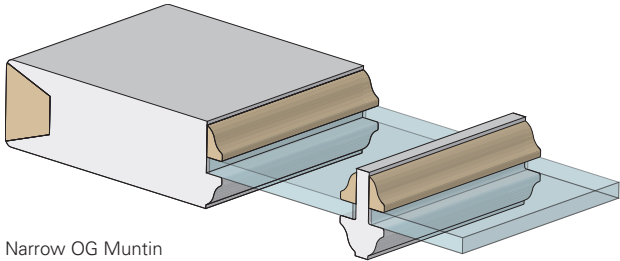

Narrow OG Muntin Bar Profile (7/8" wide)

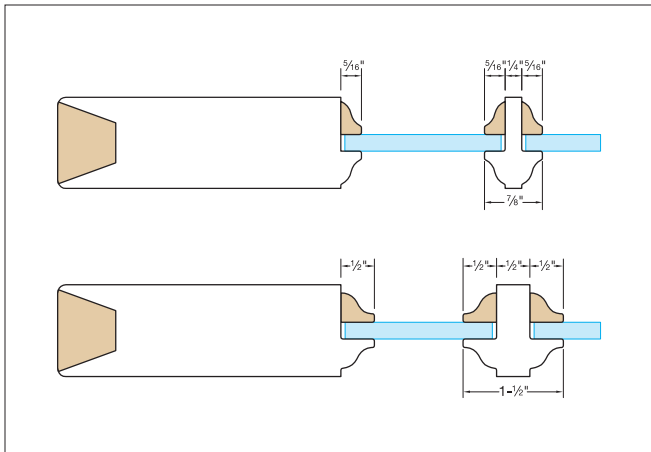

Narrow OG muntin bar profile (top) compared with standard OG muntin bar profile (bottom).

**Narrow OG Muntin Bar Cross Sections**

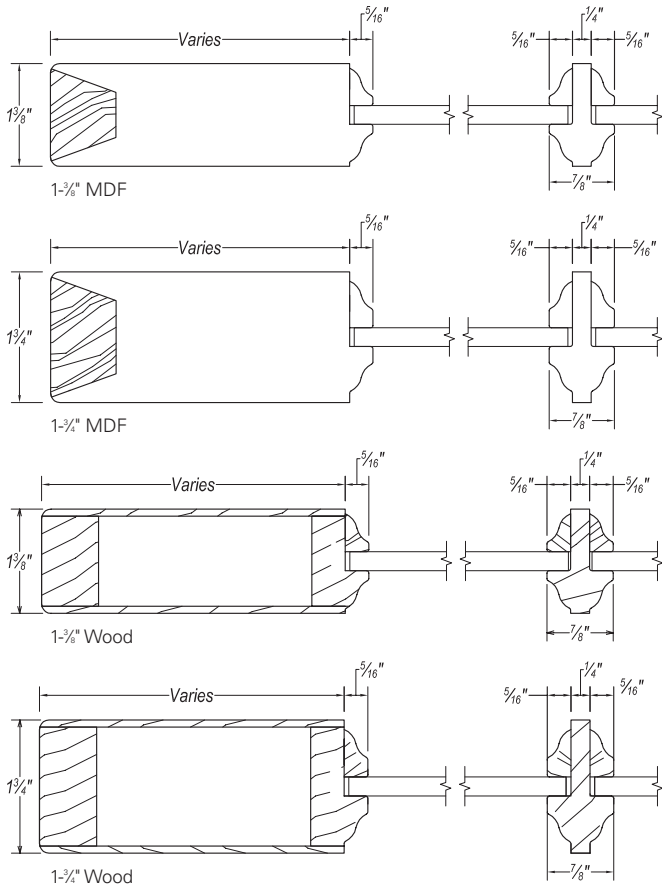

**Quality Improvement on Exterior Glass and Mirror Doors**

*Backside of Sticking to be Concealed by Colored Caulk*

In our continuous effort to improve the quality and aesthetics of our products, TruStile has changed glazing methods for exterior glass doors and mirror doors to conceal the backside of sticking with colored caulk. Moving forward, the backside of sticking on all MDF exterior glass doors will be concealed with white caulk. The backside of sticking on wood exterior glass doors and mirror doors will be concealed with black caulk.

This new glazing method provides a much more attractive look when the backside of the sticking is viewed through a 5/8" insulated glass unit or reflected off of a mirror. It also greatly reduces the chances of paint or stain seeping between the back side of the sticking and the glass during the finishing process and creating an undesirable look. Please contact your account manager if you have any questions regarding this product enhancement.



Mirror door with backside of sticking in black

## One Step (OS) Sash

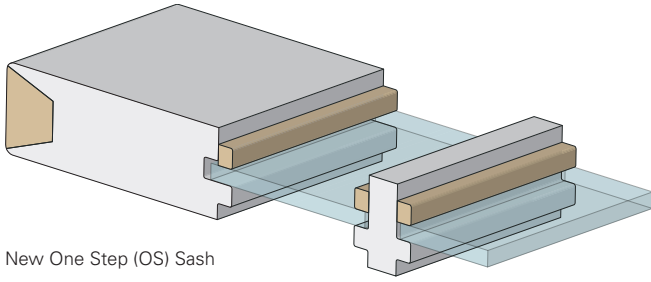

New One Step (OS) Sash

## With One Step (OS) Sash, Glass Doors Can Exactly Match OS Panel Doors

TruStile is pleased to announce One Step (OS) sash, which now enables customers who choose OS sticking on their panel doors to exactly match the sash on their glass doors. Before this new option, customers were forced to choose Square Stick (SS) sash as the closest glass door profile to match our popular OS sticking on panel doors. However, SS sash is larger than OS sash and did not provide a clean, matching look when OS sticking panel doors were positioned near a matching glass door style with SS sash.

One of the obstacles that prevented TruStile from initially offering OS sash was a lack of confidence that its small size could successfully hold large panes of glass. To address this challenge, we developed and tested a reinforced design that uses oversized glass and a special groove in the stile edge to help hold the glass in place while still allowing for glass removal and re-insertion of new glass if needed.

Now you can confidently offer the OS profile to your customers on projects with a mix of glass and panel doors knowing the profiles on all of the doors will match exactly. The OS sash option is available on all 1-3/8" and 1-3/4" TSL, PL and FL doors for a \$14 list adder.

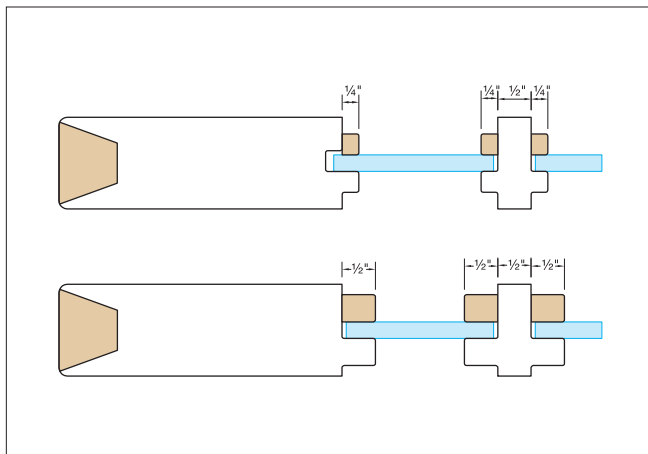

New One Step sash (top) compared with existing Square Stick sash (bottom)

## One Step Sash Cross Sections

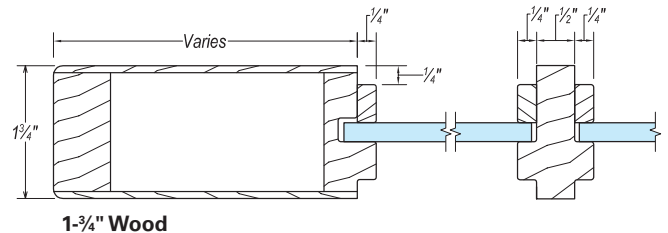
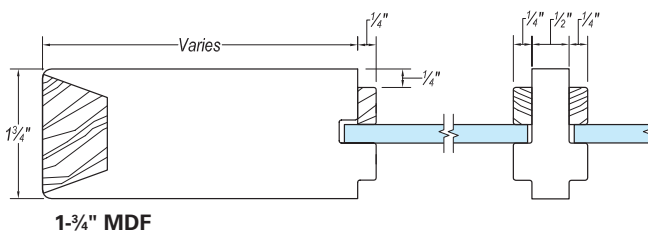
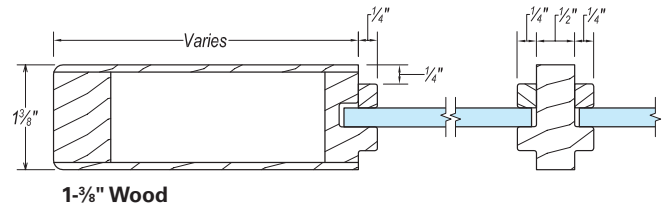
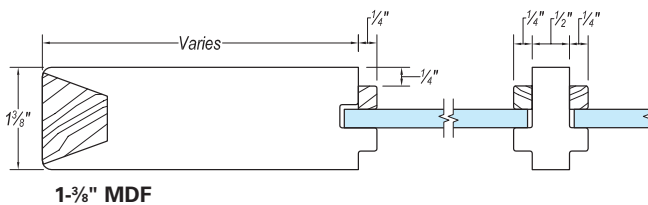

### Square Sticking Compression Fit Glass Doors Now Available to Match Square Sticking Panel Doors

TruStile has often fulfilled custom requests for glass doors to be built with glass that is compression fit directly into a groove in a square stick stile edge rather than having the glass stopped in using square stick sash. Although this means that the glass cannot be replaced if it happens to break, customers are willing to make that trade-off to achieve a glass door look that exactly matches their Square Stick panel doors.

TruStile is now making this option easier to order by making Square Stick Compression Fit glass a standard option for all 1-3/8" and 1-3/4" thick TS series doors that have the glass substituted for panels (also referred to as "TSL" series doors). Due to the compression fitting of the glass, this option is not available on door styles with muntin bars.

This new standard option is available for a \$14 list adder, the same adder price as square stick sash.

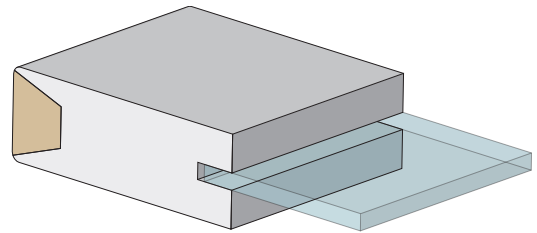

Square Stick (SS) Compression Fit Option

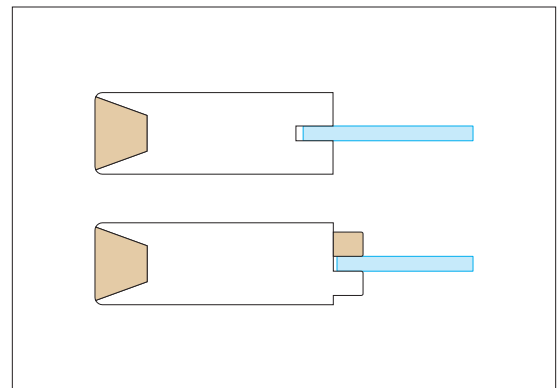

New Square Stick compression fit glass (top) compared with existing Square Stick sash (bottom)

### Square Sticking Compression Fit Cross Sections

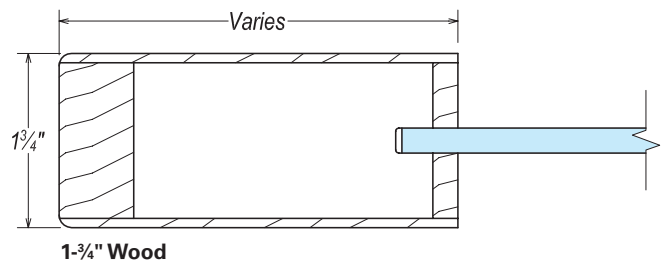
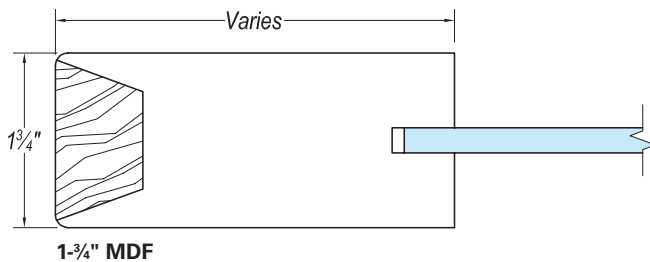
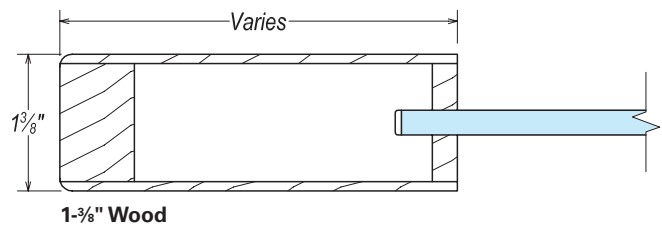
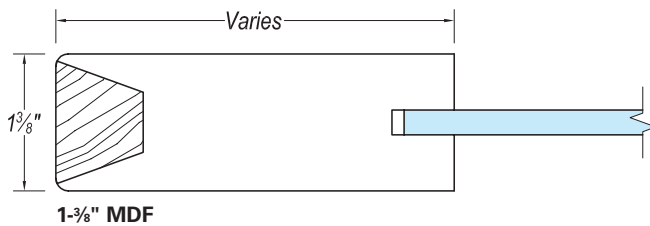

## Engineered LVL Stile Construction Available for MDF Pocket Doors

### **New Engineered LVL Stile Option will Guarantee Straight MDF Pocket Doors, Regardless of Field Handling**

Pocket doors are the doors most likely to be found warped on a job site. Why? Because they are delivered as stand alone slabs, they are often leaned against a wall or stacked in ways that allow for unequal moisture absorption on different sides of the door. This can lead to bent doors or doors that warp due to one side taking on more moisture than the other. Because TruStile knows it is difficult to change the way pocket doors are handled on job sites, we are introducing a new, extremely stiff LVL (laminated veneer lumber) core stile for MDF pocket doors.

The LVL core that will be used in our MDF pocket door stiles will be the same core that we have been using for the past year in our premium wood doors. The stiffness of this LVL core will result in stiles that will resist the bending or warping that can occur when doors are stored leaning against the wall or exposed to extreme moisture conditions before being finished. Although we are not going to require this option on all pocket doors, we recommend that it be sold with all TruStile pocket doors moving forward.

### **LVL Stile Core Removes the Need for the Top Wedge on TruStile Pocket Doors**

Because of its horizontal, layered construction, the LVL stile core has very good screw-holding strength. Since most pocket door hardware manufacturers recommend installing the door hanger into the top of the stiles of a door (where the LVL core will be located) it eliminates the need to install a top wedge into the door. It will still be recommended that you pre-drill for any hardware screws that will be inserted into the LVL. The diagram to the right illustrates the installation of pocket door hardware into a door with the new LVL stile core.



New pocket stile construction

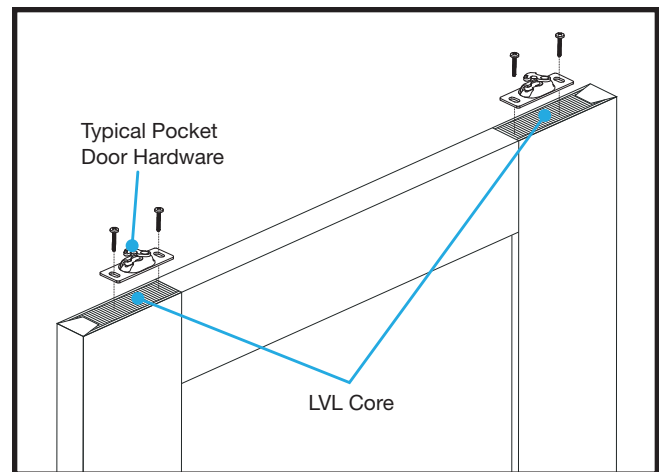

Pocket door manufacturers recommend installing hardware into the top of the stiles where new LVL core will be located thus removing the need for a top wedge.

### LVL Stile Adder Pricing is Very Affordable

As the table below displays, the adder for the new LVL core stiles will be \$60 LIST. However, pocket doors incorporating the LVL core stile no longer require the \$23 LIST Adder for the Top Wedge (see page 14). This results in an effective adder of \$37 LIST for this new construction on a pocket door. This means for less than \$20 NET you will get a pocket door guaranteed not to warp regardless of job site handling.

LIST Adder for New LVL Core Stiles	LIST Adder for Top Wedge	Effective LIST Adder for New Construction:
\$60	\$23 (No Longer Needed)	<b>\$37</b>

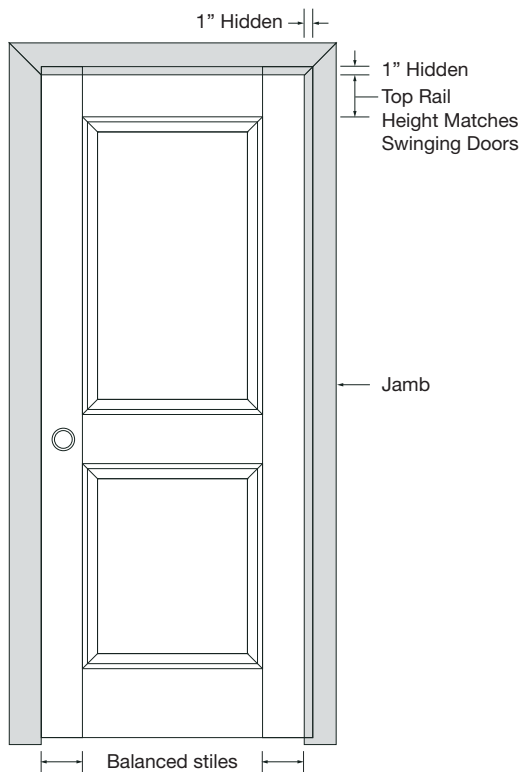

### Architecturally Correct Pocket Door Construction

With TruStile you never have to compromise design for functionality. Did you know that TruStile offers a “pocket stile” and “pocket top rail” option for pocket door applications?

The pocket stile option provides one stile that is 1" wider than the other. This allows 1" of the door to remain in the pocket when the door is fully closed, creating the appearance of equal width stiles.

The pocket top rail option adds 1" to the top rail allowing 1" of the door height to remain above the finished opening height. This provides the benefit of completely concealing all the track hardware while maintaining the same visible top rail height as other TruStile doors in the home.

**Note:** if our standard 1" specification does not work for your pocket door application, it's also easy to order a custom pocket stile width and/or a pocket top rail width to whatever dimensions you specify for a very small upcharge.

### Pricing/Ordering Information

Pocket Door Options	List Adder
Pocket Stile (1" wider)	\$10
Pocket Top Rail (1" wider)	\$10
Custom Pocket Stile Width	\$15
Custom Pocket Top Rail Width	\$15

### **Revised Stile Width Rule Guarantees 5" Stiles on Doors Over 26" Wide**

For all multiple panel doors with OG, QR, QB, TR, BV and OS sticking, TruStile's long standing stile width rules have provided 4" stiles standard on doors up to and including 30" wide doors. Doors over 30" wide have received 5" stiles. After extensive review and customer feedback, TruStile is changing the standard stile width rules for these doors. Moving forward, only doors 26" wide and less will receive 4" stiles standard. All doors over 26" will receive 5" stiles.

#### **We are making this change for several reasons:**

1. Some house packages have a large number of doors falling both below 30" and above 30". By changing our rules to only switch to 4" stiles at 26" in width, we believe that the number of doors within a house package that have 4" stiles will be relatively small and 4" stiles will only be found on doors that require them for aesthetic purposes (see below).
2. We believe all door styles look aesthetically pleasing with 5" stiles down to 26" in width. The reason TruStile must switch to 4" stiles as a standard at 26" in width is because many door styles don't look architecturally correct with 5" stiles on doors less than 26" in width. **It is important to note that customers can still request 5" stiles on *all* doors in their house packages if desired or required because of hardware escutcheon plates (see below). You can also still request 4" stile on doors up to 30" if desired.**
3. There are types of hardware escutcheon plates that are too wide for a 4" door stile. The solution for this has been for customers to specify 5" stiles across an entire house package. However, if customers using these types of escutcheon plates forgot to specify 5" stiles on all doors, then the outcome was that they couldn't use the doors that were 30" wide and less. While this rule change will still require customers to specify 5" stiles on doors 26" and less if required, fewer doors typically fall under this width within a house package. Also, to help highlight the doors within a house package that will receive 4" stiles, TruStile will note 4" stiles on all doors that are 26" and less on our quote and confirmation documents moving forward.



**Please note that the existing stile width rules for all single panel doors and doors with SS, BM, LP and QM sticking will not be impacted by this rule change, as they did not have a standard stile width rule change at the 30" in door width. See page 17 for a comprehensive listing of stile width rules for all sticking profile types.**

### Summary of Stile Width Rule Changes

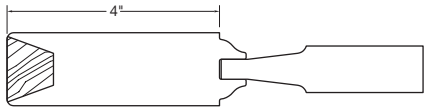
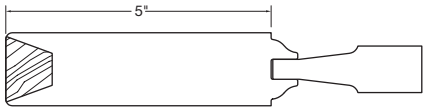
New Rules for Multiple Panel Doors with OG, QB, QR, TR, & BV Sticking

		
New Stile Width Rule	Doors up to 26" wide	Doors over 26" wide
Old Stile Width Rule	Doors up to 30" wide	Doors over 30" wide

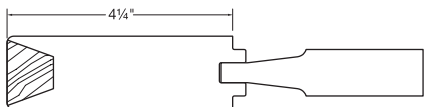
New Rules for Multiple Panel Doors with OS Sticking

		
New Stile Width Rule	Doors up to 26" wide	Doors over 26" wide
Old Stile Width Rule	Doors up to 30" wide	Doors over 30" wide

The following grids show TruStile's standard stile widths depending on door width and sticking profile. If you ever have a question about what the stile width will be for a particular door size and style, you can also visit our on-line TruCad Door Design tool on our website or our on-line Configurator to view a detailed drawing of your chosen door style and size. **Note:** All listed dimensions are face dimensions.

### TS and TSL Series Construction

	Stile Width				Top Rail Height	Bottom Rail Height
	Doors up to 16" wide	Doors over 16" wide up to 26" wide	Doors over 26" wide up to 42" wide	Doors over 42" wide	All door widths	All door widths
<b>OG, QB, QR, TR, BV Sticking</b>						
Single Panel Doors	4"	5"	5"	5-1/2"	5"	8-1/4"
Multiple Panel Doors	4"	4"	5"	5-1/2"	5"	8-1/4"
<b>SS, BM, LP, QM Sticking</b>						
Single Panel Doors	4-1/2"	5"	5"	5-1/2"	4-1/2"	8-3/4"
Multiple Panel Doors	4-1/2"	4-1/2"	4-1/2"	5-1/2"	4-1/2"	8-3/4"
<b>OS Sticking</b>						
Single Panel Doors	4-1/4"	5-1/4"	5-1/4"	5-1/2"	5-1/4"	8-1/2"
Multiple Panel Doors	4-1/4"	4-1/4"	5-1/4"	5-1/2"	5-1/4"	8-1/2"
<b>BBM Sticking</b>						
Single Panel Doors	N/A	5"	5"	5-1/2"	5"	8-1/4"
Multiple Panel Doors	N/A	5"	5"	5-1/2"	5"	8-1/4"

Continued on next page

## FL and PL Series Construction

	Stile Width				Top Rail Height	Bottom Rail Height
	Doors up to 16" wide	Doors over 16" wide up to 26" wide	Doors over 26" wide up to 42" wide	Doors over 42" wide	All door widths	All door widths
<b>OG, SS, QB, QR, OS, TR, BV, QM Sticking</b>						
Single Lite Doors	4"	5"	5"	5-1/2"	5"	8-1/4"
Multiple Lite Doors	4"	4"	5"	5-1/2"	5"	8-1/4"
<b>Applied Raised Moulding</b>						
Single Lite Doors	5"	5"	5"	5-1/2"	5"	8-1/4"
Multiple Lite Doors	5"	5"	5"	5-1/2"	5"	8-1/4"
<b>Bolection Moulding</b>						
Single Lite Doors	5"	5"	5"	5-1/2"	5"	8-1/4"
Multiple Lite Doors	N/A	N/A	N/A	N/A	N/A	N/A
<b>Big Bolection Moulding</b>						
Single Lite Doors	N/A	5"	5"	5-1/2"	5"	8-1/4"
Multiple Lite Doors	N/A	N/A	N/A	N/A	N/A	N/A

**TRUSTILE**<sup>®</sup>

[www.trustile.com](http://www.trustile.com)